

INSTALLATION INSTRUCTIONS AND USER GUIDE - FOAM SOAP DISPENSER

1. TECHNICAL SPECIFICATIONS:

Dimensions (W x H x D)	152 x 264 x 99 mm
Capacity, soap container	1000 ml, for re-fill
Battery type	4 pcs. 1.5 V Alkaline batteries type AA
Expected battery life	30,000 cycles
Net weight	0.7 kg
Activation	Automatic sensor activation
Pump function	0.6 ml soap water equals 7-9 cm ³ foam



**Wall-mounted, touch-free
and disabled friendly**

3. PRIOR TO INSTALLATION:

1. Choose a smooth, clean, vertical spot to install the dispenser.
2. Make certain that there is ample room above the dispenser to allow insertion of the housing key.
3. Make certain that there are no objects placed within the sensing range underneath the unit.
4. Test run unit before attaching it to the wall.

4. SELECT AREA FOR INSTALLATION:

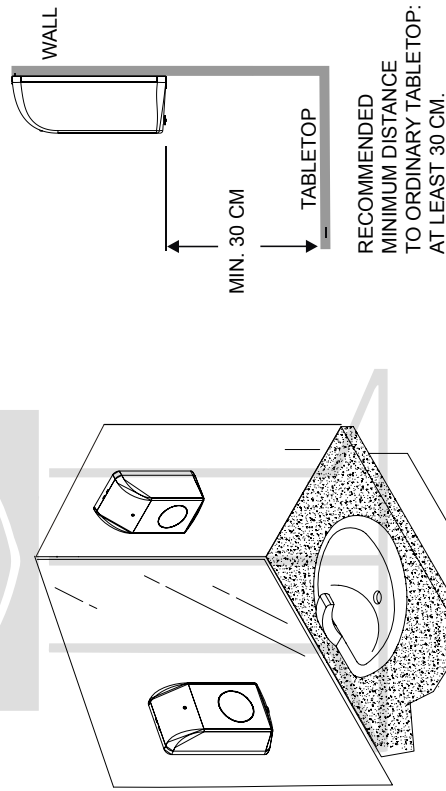

2. CHART / LIST OF COMPONENTS:

No.	Illustration	Description	Qty.	No.	Illustration	Description	Qty.
1		complete dispenser	1	8		mounting screw	4
2		installation instructions	1	9		battery compartment	1
3		template	1	10		soap container	1
4		plastic key	1	11		sensor	1
5		rawplug	4	12		housing	1
6		bottom plate	1	13		control box (excl. battery compartment)	1
7		hose with nozzle	1	14		pump	1

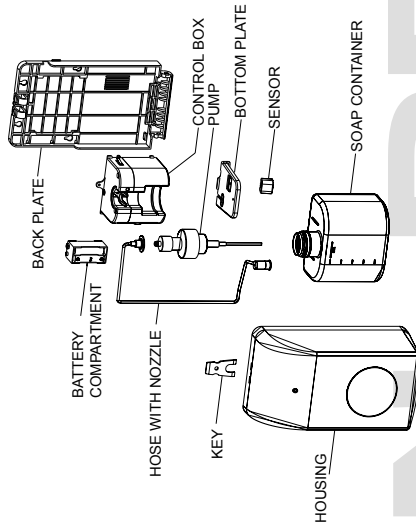

5.1 INSTALLATION ON BRICK / TILED WALL:

1. Attach template to the selected installation area on the wall using adhesive tape.
2. Drill 4 holes through the markings on the template. Apply 7 mm drill bit.
3. Remove template and place the 4 rawplugs enclosed in the holes (Cf. Fig. 1).
4. Place two of the enclosed screws in the top two holes and screw these into the wall, leaving a 3 mm gap on the screw head to the wall (Cf. Fig. 2 and 3).
5. Hang the dispenser onto the wall, letting the screw heads pass through the two top holes in the base plate.
6. Use the plastic key enclosed to open the housing. Leave housing front in open position.
7. Attach unit to the wall placing the last two screws in the corresponding bottom two holes in the baseplate. Tighten all screws (Cf. Fig. 5).

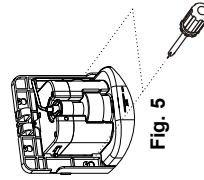
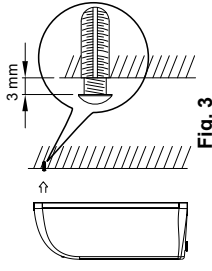
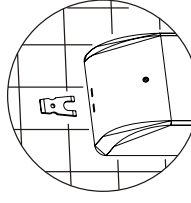
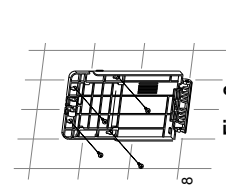
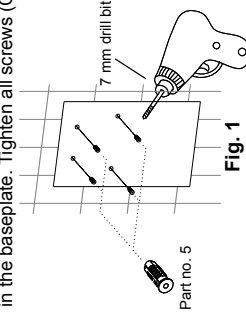

5.2 INSTALLATION / ADHERENCE ONTO MIRROR:

1. Clean the selected area of installation.
2. Masking tape may be used to outline the dispenser on the mirror to ensure accurate installation.
3. Remove the protective foil from the double-sided tape placed on the back of the base plate.
4. Press unit onto the desired area of installation and hold pressure evenly for approx. 1 minute. Remove masking tape if applied.
5. Leave double-sided tape to affix for 10 hours before adding soap water.

6. CHECK LIST PRIOR TO USE:

1. Ensure that the dispenser is firmly attached to the installation area selected.
2. Ensure that the correct solution of diluted soap has been filled into the soap container.
3. Ensure that the pump has been screwed onto the soap container with a tight fit.
4. Ensure that the soap container does not leak and that no soap has been spilled.
5. Ensure that the two-toothed plastic fork at the top of the pump recess in the control box is in place, allowing for the soap container with pump to be pushed in place in the recess (cf. Fig. 6).
6. Soap re-fill (cf. Fig. 7):
 - a. Use plastic key to open housing.
 - b. Remove soap container from control box.
 - c. Unscrew pump lid.
 - d. Disassemble pump from soap container by turning the pump counter-clockwise.
 - e. Add soap and water.
 - f. Reassemble pump lid and push the soap container back in place in the control box recess.
7. Ensure that the four new Alkaline batteries type AA have been placed correctly in the battery compartment.
8. Ensure that the connector for the battery compartment has been correctly connected to the cable, and that the battery compartment lid is in place.
9. Ensure that the hose with nozzle is placed correctly, that it is screwed firmly onto the pump, and that it is not under pressure.
10. Ensure that the LED diode lights up blue and then flashes 4 times.

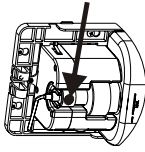

Fig. 6

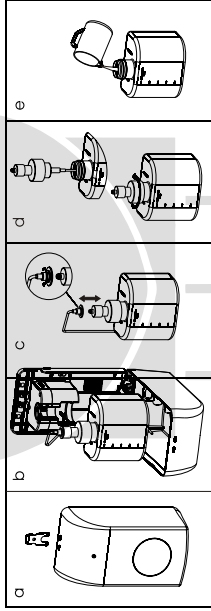

Fig. 7

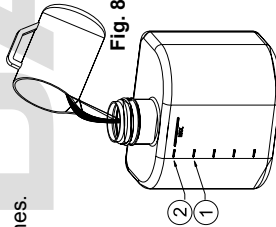

Fig. 8

7. USER GUIDE:

- ### A. Service instructions
1. Use plastic key to open housing.
 2. Remove lid from battery compartment; disassemble compartment and disconnect cable. Insert 4 new 1.5 V Alkaline batteries type AA, ensuring correct positioning (cf. Fig. 9).
 3. Reassemble battery compartment and lid.
 4. Fill up the soap container, so it contains 1000 ml diluted soap (soap : water ratio approx. 1-4). Pour water into the container up until line mark ①; then add soap up until line mark ②. Shake the soap container to mix fluids. (Cf. Fig. 8).
 5. Ensure that the nozzle is not clogged up and that the soap container is clean (no leakage or spillage). Put the soap container back in place inside the dispenser housing. Ensure to keep dispenser components dry at all times.
 6. Ensure that the LED lights up blue and then flashes 4 times to indicate that the soap dispenser is ready for use.
 7. The sensor automatically adjusts to optimum activation distance. Manual adjustment is not possible.
 8. The housing automatically locks when closed. Keep the plastic key in a safe place.
 9. Test functionality / correct dosage 5-6 times.

B. Instructions for use

1. Place one hand within the sensing range underneath the dispenser nozzle. Foam soap will automatically be dispensed from the nozzle.
2. For a second dosage of foam, remove hand and place it once more within the sensing range underneath the nozzle.



Ensure that batteries are positioned correctly inside the battery compartment

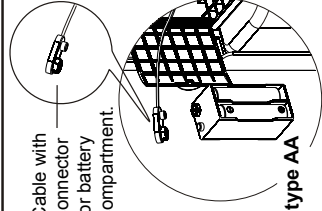

4 pcs. 1.5 V batteries type AA

Fig. 8

8. IMPORTANT:

1. Ensure that no source of light points directly at or reflects up into the sensor from below.
2. Apply diluted soap and clean soap container thoroughly in connection with each re-fill. Old soap suds will lead to clogging and malfunction. No more than one week should pass after the dispenser has run dry until soap is re-filled.
3. Do not apply soap containing abrasives. Check viscosity of the diluted soap.
4. All components inside the foam soap dispenser must be kept dry at all times. Ensure that the pump lid has been screwed on tight. If water or soap spills into the control box, this may cause a short circuit.
5. If new batteries have been inserted, and the dispenser does not work, we recommend you not to make further attempts to repair the unit on your own. Contact DAN DRYER A/S for assistance.

9. INDICATION OF LOW BATTERY LEVEL:

1. If the LED keeps flashing, this indicates the need for battery replacement.
2. When batteries have been replaced, the LED diode must light up blue and then flash 4 times to indicate that the soap dispenser is ready for dosage.
3. If the LED does not work after battery replacement, this may be because the control box is faulty. Contact DAN DRYER A/S for assistance.

10. TROUBLE-SHOOTING:

Description of malfunction	Solution
No dosage	<ol style="list-style-type: none"> 1. Check soap quality/properties - as well as soap level in container. 2. Check sensor for dust and dirt. 3. Replace batteries. 4. If the LED diode flashes, replace pump, hose and nozzle. 5. Replace above components after 50,000 dosages or 1 year of operation.
The LED, which should indicate the need for battery replacement, does not flash	<ol style="list-style-type: none"> 1. Replace batteries and check that the LED diode flashes. 2. If the dispenser still does not work after battery replacement, the control box may be faulty. Contact DAN DRYER A/S for assistance.
Too little foam soap is dispensed	<ol style="list-style-type: none"> 1. Check soap quality/properties - as well as soap level in container. 2. Replace batteries. 3. Replace pump, hose and nozzle.
Soap leakage from the bottom of the housing	<ol style="list-style-type: none"> 1. Check that the soap container has not been damaged / does not leak. 2. Check that soap water has not overflowed in connection with re-fill. 3. Replace pump, hose and nozzle.